

# INDEX TO INVENTORY FORMS

Adam's Cottage  
 Ahner, Dan  
 Bake Oven  
 Bauman, Sam  
 Bauman, Edward  
 Bauman, John  
 Bauman, Samuel  
 Bauman, William  
 Baumler, Fred  
 Bayview Hotel  
 Beatty, Arthur's Pre Fab  
 Beatty House  
 Beaver  
 Bechtel, Lydia  
 Becker, William  
 Becker, William  
 Becker, Rueben  
 Becker, George Farm  
 Bertsche, J. A.  
 Betzenheimer, Geraldine  
 Betzenheimer, Jack  
 Betzenheimer, Francis  
 Bianchi, Nick & Sharon  
 Bianchi, Josephine  
 Bickley, Herbert  
 Big Dock  
 "Big House"  
 Bier, John & Richard  
 Blatt, N. Theodore & Barbara  
 Blatt, John  
 Bloom, Dr. Ward  
 Bockerman, Marshall  
 Bockerman, Marshall & Sandra  
 Bonchi, Evangeline  
 Bouslay, Wayne J.  
 Bowling Alley, The  
 Brennan, Hugh  
 Brennan, Michael  
 Bristol, George  
 Bristol, George  
 Brown, Howard  
 Brown, Roland  
 Brown, Otto  
 Brown, Otto Winery  
 Brown's General Store  
 Bucsi, Teresa  
 Buergler, Frank & Fred  
 Bunk, Fred  
 Burger, William Hse. & Mortuary  
 Burger, Wm. Res. & Mortuary  
 Burger, John  
 Burre, Robert  
 Calkins, George  
 Cameron, Andrew  
 Cameron, John  
 Camp Patmos  
 Carpenter, Charles  
 Carpenter, Lester  
 Carpenter's Fruit Cellar  
 Carpenter's "First" Wine Cellar

ERI-1725  
 ERI-1657  
 ERI-1627  
 ERI-1651  
 ERI-1580  
 ERI-1635  
 ERI-1662  
 ERI-1594  
 ERI-1585  
 ERI-1640  
 ERI-1657  
 ERI-1653  
 ERI-1632  
 ERI-1743  
 ERI-1677  
 ERI-1635  
 ERI-1748  
 ERI-1746  
 ERI-1584  
 ERI-1586  
 ERI-1520  
 ERI-1718  
 ERI-1587  
 ERI-1713  
 ERI-1718  
 ERI-1628  
 ERI-1746  
 ERI-1706  
 ERI-1595  
 ERI-1655  
 ERI-1694  
 ERI-1528  
 ERI-1534  
 ERI-1715  
 ERI-1607  
 ERI-1643  
 ERI-1523  
 ERI-1597  
 ERI-1694  
 ERI-1743  
 ERI-1552  
 ERI-1656  
 ERI-1619  
 ERI-1618  
 ERI-1559  
 ERI-1611  
 ERI-1544  
 ERI-1689  
 ERI-1611  
 ERI-1690  
 ERI-1611  
 ERI-1521  
 ERI-1720  
 ERI-1669  
 ERI-1608  
 ERI-1663  
 ERI-1704  
 ERI-1724  
 ERI-1725  
 ERI-1706

Water St.  
 E. Lake Shore Rd.  
 Division Street  
 E. Lake Shore Rd.  
 Division Street  
 Airport Rd.  
 Monaghan Rd.  
 Division Street  
 Division Street  
 E. Lake Shore Rd.  
 E. Lake Shore Rd.  
 E. Lake Shore Rd.  
 Dwelle Lane  
 Woodford Rd.  
 Ward Rd.  
 Airport Rd.  
 Woodford Rd.  
 Woodford Rd.  
 Division Street  
 Division Street  
 Huntington Ln.  
 Water St.  
 Division Street  
 Water St.  
 Water St.  
 Division St.  
 Woodford Rd.  
 Water St.  
 Division Street  
 E. Lake Shore Rd.  
 Water St.  
 Addison Place  
 Cameron Road  
 Water St.  
 Division St.  
 E. Lake Shore Rd.  
 Huntington Ln.  
 Division St.  
 Water St.  
 Woodford Rd.  
 Chappel Street  
 E. Lake Shore Rd.  
 Division Street  
 Division Street  
 Division Street  
 Division Street  
 Bookerman Road  
 Water St.  
 Division Street  
 Water St.  
 Division Street  
 Huntington Ln.  
 Water St.  
 Titus Rd.  
 Division Street  
 Monaghan Rd.  
 Water St.  
 Water St.  
 Water ST.  
 Water St.

Carpenter's Wine Cellar  
 Carver, Lewis  
 Casino  
 Cattanaugh, Hugh  
 Celeste, Gov. Richard F.  
 Chigger Hollow  
 Chisholm, Stewart  
 Clapp, Emil  
 Cleary, Jeannette & George  
 Coleman, Wm. & Barbara  
 Community Bake Oven  
 Community Church  
 Conkle/Lindcamp  
 Conkle/Lindcamp  
 Conkle/Lindcamp  
 Conkle, Willaim  
 Coulon, Robert  
 Cozy Corner  
 Craft, Elmer  
 Craft's Lakeview Ln. Cottages  
 Craft's Lakeview Ln. Cottages  
 Craft's Lakeview Ln. Cottages  
 Craft's Lakeview Ln. Cottages  
 Craft's Lakeview Ln. Cottages  
 Cricket Lodge  
 Cropper, Jo Ann  
 Crotser, William  
 Crusher, South Side  
 Curilla, Edward  
 Curilla, Edward  
 Curilla, Edward  
 Dainty's. Bessie  
 Dean, Jerry  
 Dean, Oscar  
 DeBord, Caroline & Richard  
 Diffley, Peter,  
 Dirty Don's  
 Ditchey's  
 Doctor's House  
 Dodge, Charles  
 Dodge, Charles First Hse.  
 Dodge, Otto  
 Duignan, Patrick  
 Dwelle, Nelson  
 Dwelle, Sylvester  
 Dwelle, Jared  
 Dwelle, Jean  
 Dwelle, Jared  
 Dwelle, Alonzo  
 East-a-Ways  
 Ehrbar, Adelbert & Laverne  
 Elfer's, (Fred) First Store  
 Elfer's Store  
 Elfers, Frederick  
 Elfers, Walter  
 Elfers, Arnold  
 Erne, Karl  
 Erne, Charles  
 Erne, Roy & Iva  
 Estes School  
 Estes, James  
 Fair Harbor  
 Fann, Dr. George C.  
 Farciot, Charles W.  
 Fedderson (aka Fetterson), Christian  
 Feyedelem, Joseph

ERI-1705  
 ERI-1537  
 ERI-1561  
 ERI-1668  
 ERI-1635  
 ERI-1534  
 ERI-1684  
 ERI-1615  
 ERI-1527  
 ERI-1545  
 ERI-1627  
 ERI-1548  
 ERI-1736  
 ERI-1733  
 ERI-1737  
 ERI-1683  
 ERI-1642  
 ERI-1679  
 ERI-1520  
 ERI-1708  
 ERI-1709  
 ERI-1711  
 ERI-1712  
 ERI-1710  
 ERI-1639  
 ERI-1604  
 ERI-1525  
 ERI-1723  
 ERI-1523  
 ERI-1522  
 ERI-1638  
 ERI-1555  
 ERI-1566  
 ERI-1666  
 ERI-1647  
 ERI-1695  
 ERI-1561  
 ERI-1649  
 ERI-1567  
 ERI-1675  
 ERI-1733  
 ERI-1735  
 ERI-1687  
 ERI-1584  
 ERI-1633  
 ERI-1632  
 ERI-1566  
 ERI-1693  
 ERI-1634  
 ERI-1754  
 ERI-1526  
 ERI-1626  
 ERI-1564  
 ERI-1528  
 ERI-1529  
 ERI-1695  
 ERI-1589  
 ERI-1675  
 ERI-1598  
 ERI-1610  
 ERI-1656  
 ERI-1683  
 ERI-1578  
 ERI-1688  
 ERI-1556  
 ERI-1716

Water St.  
 Bookerman Rd.  
 Division Street  
 Titus Rd.  
 Airport Rd.  
 Cameron Road  
 Water St.  
 Division St.  
 Addison Place  
 Bookerman Road  
 Division Street  
 Chappel Street  
 Water St.  
 Water St.  
 Water St.  
 Water St.  
 E. Lake Shore Rd.  
 Ward Rd.  
 Huntington Ln.  
 Water St.  
 Water St.  
 Water St.  
 Water St.  
 E. Lake Shore Rd.  
 Division Street  
 Addison Place  
 Water St.  
 Huntington Ln.  
 Huntington Ln.  
 E. Lake Shore Dr.  
 Chappel Street  
 Division Street  
 Titus Rd.  
 E. Lake Shore Rd.  
 Water St.  
 Division Street  
 E. Lake Shore Rd.  
 Division Street  
 Ward Rd.  
 Water St.  
 Water St.  
 Water St.  
 Division Steet  
 Dwelle Ln.  
 Dwelle Lane  
 Division Street  
 Water St.  
 Dwelle Ln.  
 McGettigan Ln.  
 Addison Place  
 Division Street  
 Division Street  
 Addison Place  
 Addison Place  
 Water St.  
 Division Street  
 Ward Rd.  
 Division Street  
 Division Street  
 E. Lake Shore Rd.  
 Water St.  
 Division Street  
 Water St.  
 Chappel Street  
 Water St.



Feyedelem, Michael  
 Finger, William  
 Fisher, Charles  
 Fisher, Charles Wine House  
 Four-H (4-H) Camp  
 Garrett, H.  
 Garrett, Daniel  
 Gehrkins, Frederick  
 General Store  
 Gerlach, George  
 German Evangelical Church  
 German Evangelical Church  
 German Reformed Church  
 Gorchester, William  
 Gorchester, William & Ferne  
 Gorchester, William & Ferne  
 Goudreau  
 Goudreau  
 Grun (aka Green), Frederick  
 Guerin, Mamie  
 Haas, Don  
 Haas, Donald  
 Haley, John (aka Healey)  
 Hamilton, Sam'l. & Robert  
 Hassel's Haven  
 Hauser, Frank  
 Hauser, John  
 Hauser, Minnie  
 Haydon/Mooney  
 Heckerman, August  
 High School, First  
 Himmelein, Charles  
 Himmelein, John & Beatrice  
 Himmelein Hotel  
 Hipp, Leonard  
 Hodgson, James & Poppy  
 Holdron, Lynn & Debarah  
 "Hotel Victory"  
 Howlette, M.P.  
 Huber, Ward  
 Hughes, Claayton & Elise  
 Humel, Dr. Robert  
 Huntington, George  
 Huntington, Erastus  
 Huntington, Erastus  
 Huntington, Daniel  
 Huntington, Dan'l.  
 Huntington, Simon  
 Inn, The  
 Inter-Urban Baggage Car  
 Island House Restaurant  
 Island Market  
 James, Steve & Laurie  
 Johnson, Jay-Gift Shop  
 Johnson, Paul & Beverly  
 Jordan, Henry  
 Kamp Kellile  
 Kekellik, Dawn  
 Kaneen,  
 Kastning, Frederick  
 Kelley, Frederick  
 Kelley, Norman Co. Worker's Hse,  
 Kelley, Norman Co. Worker's Hse,  
 Kelley, Wm. D.  
 Kelley, Nancy  
 Kelley Island Wine Co.

ERI-1531	Cameron Road
ERI-1551	Chappel Street
ERI-1616	Division Street
ERI-1617	Division Street
ERI-1676	Ward Rd
ERI-1600	Division Street
ERI-1652	E. Lake Shore Rd.
ERI-1533	Chappel Street
ERI-1559	Division St.
ERI-1605	Division Street
ERI-1622	Division Street
ERI-1548	Chappel Street
ERI-1581	Division Street
ERI-1658	E. Lake Shore Rd.
ERI-1655	E. Lake Shore Rd.
ERI-1654	E. Lake Shore Rd.
ERI-1616	Division Street
ERI-1617	Division Street
ERI-1718	Water St.
ERI-1720	Water St.
ERI-1626	Division Street
ERI-1580	Division Street
ERI-1591	Division Street
ERI-1663	Monaghan Rd.
ERI-1660	Monaghan Rd.
ERI-1607	Division St.
ERI-1604	Division Street
ERI-1598	Division Street
ERI-1585	Division Street
ERI-1733	Water St.
ERI-1606	Division Street
ERI-1638	E. Lake Shore Rd.
ERI-1639	E. Lake Shore Rd.
ERI-1642	E. Lake Shore Rd.
ERI-1524	Huntington Ln.
ERI-1528	Addison Place
ERI-1594	Division Street
ERI-1519	Huntington Ln.
ERI-1616	Division Street
ERI-1646	E. Lake Shore Rd.
ERI-1622	Division Street
ERI-1647	E. Lake Shore Rd.
ERI-1698	Water St.
ERI-1545	Bookerman Road
ERI-1707	Water St.
ERI-1543	Bookerman Road
ERI-1693	Water St.
ERI-1700	Water St.
ERI-1707	Water St.
ERI-1717	Water St.
ERI-1573	Division Street
ERI-1563	Division St.
ERI-1589	Division Street
ERI-1631	Water St.
ERI-1619	Division Street
ERI-1592	Division Street
ERI-1703	Water St.
ERI-1570	Woodford Rd
ERI-1740	Woodford Rd.
ERI-1736	Water St.
ERI-1527	Addison Place
ERI-1711	Water St.
ERI-1712	Water St.
ERI-1685	Water St.
ERI-1685	Water St.
ERI-1705	Water St.

Kelley, Norman Co. Workers Hse.  
 Kelley, Norman & Co. Office  
 Kelley, Norman Co. Worker's Hse,  
 Kelley, Norman Co. Worker's Hse,  
 Kelley, Norman  
 Kelley, Addison Tenant Hse.  
 Kelley, Norman & Co. Worker's House  
 Kelley, Charles & Edwin  
 Kelley, Frank  
 Kelley, Gustavus Aldolphus  
 Kelley, Henry  
 Kelley Island Wine Company Ruins  
 Kelley, Frank Tenant Hse.  
 Kelley Mansion  
 Kelley's Hall  
 Kelley's, Datus First Res.  
 Kelley, George Res. & Store  
 KIL&T Co. Worker's House  
 KIL&T Co. Worker's House  
 KIL&T Co. Worker's House  
 KIL&T Co. Worker's House  
 KILT Co. Worker's Hse. #59  
 KILT Worker's Hse # 58  
 KILT Co. Worker's Hse. #49  
 KILT Co. Worker's Hse. # 61  
 KILT Co. Worker's Hse.  
 KILT Co. Worker's House #55  
 KILT Co. Worker's House #  
 Kirby, Elaine  
 Kirk, Elizabeth  
 Knapik  
 Knapp, Barbara  
 Knauer, George  
 Koenigseker, Col.  
 Koster, Hermann  
 Koster's Dock  
 Kromer, Paul  
 Krupa, Michael  
 Lang, Henry  
 Lang, Henry  
 Lange, Hugh  
 Lange, John  
 Lange, Frederick  
 Lange, Ivan T. & Jane  
 Lange, Arthur  
 Leidheiser, Paul  
 Lemley, Garnet  
 Lentz, Edward  
 Leo, Angeline  
 Leyden, Patrick  
 Lichtenberg, J.  
 Lime Kiln, South Side  
 Limestone Culvert  
 Limestone Cullvert  
 Lincoln, Montgomery  
 Lindecamp, Charles  
 Lindecamp/Conkle  
 "Little Beatty Church"  
 Livosz,  
 "Lodge, The"  
 Lutzens (aka Lutyens), Christopher  
 Maag, Daniel House & Winery  
 McCune Rectory & Res.  
 McGettigan, Dan  
 McKillips, Oscar's Work Shop  
 McKillips, Norbert

ERI-1708  
 ERI-1716  
 ERI-1710  
 ERI-1709  
 ERI-1721  
 ERI-1748  
 ERI-1531  
 ERI-1604  
 ERI-1525  
 ERI-1684  
 ERI-1683  
 ERI-1535  
 ERI-1651  
 ERI-1645  
 ERI-1560  
 ERI-1565  
 ERI-1565  
 ERI-1531  
 ERI-1577  
 ERI-1533  
 ERI-1534  
 ERI-1671  
 ERI-1714  
 ERI-1537  
 ERI-1715  
 ERI-1713  
 ERI-1716  
 ERI-1631  
 ERI-1621  
 ERI-1749  
 ERI-1661  
 ERI-1599  
 ERI-1742  
 ERI-1593  
 ERI-1530  
 ERI-1650  
 ERI-1599  
 ERI-1741  
 ERI-1644  
 ERI-1553  
 ERI-1603  
 ERI-1667  
 ERI-1600  
 ERI-1555  
 ERI-1695  
 ERI-1672  
 ERI-1645  
 ERI-1637  
 ERI-1732  
 ERI-1522  
 ERI-1550  
 ERI-1536  
 ERI-1582  
 ERI-1630  
 ERI-1593  
 ERI-1672  
 ERI-1733  
 ERI-1622  
 ERI-1601  
 ERI-1562  
 ERI-1568  
 ERI-1543  
 ERI-1756  
 ERI-1575  
 ERI-1626  
 ERI-1702

Water St.  
 Water St.  
 Water St.  
 Water St.  
 Water St.  
 Woodford Rd.  
 Cameron Road  
 Division Street  
 Addison Place  
 Water St.  
 Water St.  
 Cameron Road  
 E. Lake Shore Rd.  
 Addison Rd.  
 Division Street  
 Division Street  
 Division Street  
 Cameron Road  
 Division Street  
 Cameron Road  
 Cameron Road  
 Water St.  
 Water St.  
 Bookerman Rd.  
 Water St.  
 Water St.  
 Water St.  
 Water St.  
 Division St.  
 Woodford Rd.  
 Monaghan Rd.  
 Division Street  
 Woodford Rd.  
 Division Street  
 Addison Place  
 E. Lake Shore Rd.  
 Division Street  
 Woodford Rd.  
 E. Lake Shore Rd.  
 Chappel Street  
 Division Street  
 Titus Rd.  
 Division Street  
 Chappel Street  
 Water St.  
 Ward Rd.  
 Addison Rd.  
 Lincoln Rd.  
 Water St.  
 Huntington Ln.  
 Chappel Street  
 Cameron Road  
 Monaghan Rd.  
 Division  
 Division Street  
 Ward Rd.  
 Water ST.  
 Division Street  
 Division Street  
 Water St.  
 Division Street  
 Bookerman Road  
 McGettigan Rd.  
 Division Street  
 Division Street  
 Woodford Rd.



McKillips, Florence ("Sis")	ERI-I583	Division Street
McKillips, Oscar & M. Augusta	ERI-I576	Division Street
McMonagle, Judge Richard	ERI-I728	Water St.
Maag, Howard	ERI-I717	Water St.
Mack, Paul	ERI-I605	Division Street
Mapleville	ERI-I620	Division Street
Marchky, Helen	ERI-I553	Chappel Street
"Martin's"	ERI-I682	Water St.
Marcus Village	ERI-I612	Division Street
Martin, Fritz	ERI-I586	Division Street
Mathes, Ann	ERI-I649	E. Lake Shore Rd.
Mathes,	ERI-I687	Water St.
Matso Cottage	ERI-I579	Division Street
Matso, Russell & Beatrice	ERI-I578	Division Street
Matso's Place	ERI-I562	Water St.
Matthews, Lucille	ERI-I529	Addison Place
May, John & Thomas	ERI-I739	Woodford Rd.
Meyers, Fred	ERI-I603	Division Street
Meyers, Leroy	ERI-I684	Water St.
Michaels, (aka Michaelis), Chris.	ERI-I590	Division Street
Mielke, Paul	ERI-I748	Woodford Rd.
Miller, Karl	ERI-I594	Division Street
Miller, Burt	ERI-I565	Division Street
Miller, John	ERI-I602	Division Street
Minshall, William	ERI-I669	Titus Rd.
Minshall, Werner	ERI-I668	Titus Rd.
Minshall, Willaim E.	ERI-I667	Titus Rd.
Mischler, "Moody"	ERI-I595	Division Street
Mischler, Daniel	ERI-I674	Ward Rd.
Mischler's Meat Market	ERI-I587	Division Street
Moeck House	ERI-I595	Division Street
Monaghan, John	ERI-I758	Harbor Ln.
Monarch Wine Co. Ruins	ERI-I618	Division Street
Moore, Capt. Orton E.	ERI-I692	Water ST.
Moore, Charles	ERI-I588	Division Street
Morning Glory Farm	ERI-I756	McGettigan Rd.
Morton, George	ERI-I612	Division Street
Mounting Block, "The Bayview"	ERI-I659	E. Lake Shore Rd.
Moysey, William, Carriage Block	ERI-I659	E. Lake Shore Rd.
Murphy, Patrick	ERI-I521	Huntington Ln.
Navorska, Mary	ERI-I704	Water St.
Newcomb, Margaret	ERI-I689	Water ST.
Norris, Jay	ERI-I575	Division Street
Nowalk, Don & Donna	ERI-I636	Lincoln Rd.
"Old Nest, The"	ERI-I688	Water St.
"Other House, The"	ERI-I721	Water St.
O'Toole's	ERI-I553	Chappel Street
Orchard Haven	ERI-I556	Chappel Street
Our-Hide-Away	ERI-I606	Division Street
Overcashier, Robert	ERI-I634	Dwelle Ln.
Overcashier's Island Hotel	ERI-I640	E. Lake Shore Rd.
Palazza, Nancy	ERI-I543	Bookerman Road
Parsonage, German Reformed Church	ERI-I583	Division Street
Parsonage, German Evangelical Church	ERI-I549	Chappel Street
Parsonage, Zion United Methodist Ch.	ERI-I549	Chappel Street
Pascoe, Charles	ERI-I552	Chappel Street
Pearson, Harry	ERI-I739	Woodford Rd.
Peg's Place	ERI-I747	Woodford Rd.
Perkinson, Edward	ERI-I552	Chappel Street
Perkinson, Michael	ERI-I551	Chappel Street
Perruchon, Ruth	ERI-I742	Woodford Rd.
Peters, Wm. & Melba	ERI-I591	Division Street
Pleasant View	ERI-I724	Water St.
Plonski, Joseph	ERI-I656	E. Lake Shore Rd.
Pogon	ERI-I652	E. Lake Shore Rd.
Pohorence, Frank & Laura J.	ERI-I602	Division Street

Pohorence, Joseph & Anne  
 Police Dept. & Jail, Kelley Island  
 Post 8908, VFW  
 Pringnitz, Henry  
 "Pump, The"  
 Quarry Worker's House # 76  
 Quarry Store Offices  
 Quarry Hollow  
 Quinn, Thomas & Charles  
 Reinheimer, Frank  
 Reinheimer, John B.  
 Riedy, Robert  
 Riedy, Henry  
 Riedy, John B.  
 Riedy, Pauline House & Winery  
 Riedy, Iola  
 Riedy, John Res. & Winery  
 Rohrs, Fred  
 Rom, Marily  
 Rosswurm, Philip  
 Rumel, Al  
 Rush, Jacob Winery  
 Rush, (aka Roesch), Mary  
 Russell, James & Eila  
 Ruthsatz, Paul  
 St. Michael's Rectory  
 St. Michael's Roman Catholic Church  
 Saylor, Thomas K.  
 Schaaedler, August Wine Cellar  
 Schaedler & Rhein Winery  
 Schaedler, Andrew  
 Schaedler, August  
 Schaedler, John  
 Schardt, George  
 Scheele, Arnold  
 Schlesselman, Ollie  
 Schlesselman, Henry  
 Schlesselman, Albert  
 Schlesselman, William  
 Schlumbohm, Katherine  
 Schneider, Clark & Eleanor  
 Schnittker, Robert  
 Schnittker, (Charles) & Ruth  
 Schnittker, August  
 Schock, Godfried  
 Schoewe,  
 School, The East Side  
 Seaman, James & Martha  
 Seeholzer, Charles  
 Seeholzer, Charles & Son Winery  
 Seeholzer, Carl  
 Seeholzer  
 Seeholzer, James & Pat  
 Sennish, Elko  
 Sennish, Esther  
 Sennish, Jack  
 Seton, James  
 Shadowski House  
 Shippel, Frederick Hse. & Winery  
 "Silk Purse"  
 Smith, Thom & Nadine  
 Smith, Louis  
 Smith, Nick  
 Smith, Harold  
 Starkweather, L.  
 Steam Boat Dock

ERI-I530  
 ERI-I623  
 ERI-I614  
 ERI-I636  
 ERI-I682  
 ERI-I544  
 ERI-I542  
 ERI-I674  
 ERI-I741  
 ERI-I588  
 ERI-I584  
 ERI-I601  
 ERI-I752  
 ERI-I604  
 ERI-I557  
 ERI-I574  
 ERI-I609  
 ERI-I661  
 ERI-I609  
 ERI-I523  
 ERI-I686  
 ERI-I618  
 ERI-I755  
 ERI-I524  
 ERI-I608  
 ERI-I738  
 ERI-I558  
 ERI-I592  
 ERI-I658  
 ERI-I703  
 ERI-I737  
 ERI-I654  
 ERI-I732  
 ERI-I731  
 ERI-I689  
 ERI-I692  
 ERI-I749  
 ERI-I596  
 ERI-I569  
 ERI-I613  
 ERI-I646  
 ERI-I695  
 ERI-I600  
 ERI-I568  
 ERI-I572  
 ERI-I590  
 ERI-I660  
 ERI-I653  
 ERI-I702  
 ERI-I701  
 ERI-I740  
 ERI-I644  
 ERI-I596  
 ERI-I621  
 ERI-I665  
 ERI-I665  
 ERI-I676  
 ERI-I577  
 ERI-I655  
 ERI-I662  
 ERI-I519  
 ERI-I558  
 ERI-I745  
 ERI-I569  
 ERI-I635  
 ERI-I628

Addison Place  
 Division Street  
 Division St.  
 Lincoln Rd.  
 Water St.  
 Bookerman Road  
 Bookerman Road  
 Ward Rd.  
 Woodford Rd.  
 Division Street  
 Division Street  
 Division Street  
 Woodford Rd.  
 Division Street  
 Chappel Street  
 Division Street  
 Division Street  
 Monaghan Rd.  
 Division Street  
 Huntington Ln.  
 Water St.  
 Division Street  
 Division St.  
 Huntington Ln.  
 Division Street  
 Woodford Rd.  
 Chappel Street  
 Division Street  
 E. Lake Shore Rd.  
 Water St.  
 Water St.  
 E. Lake Shore Rd.  
 Water St.  
 Water St.  
 Water St.  
 Water St.  
 Woodford Rd.  
 Division Street  
 Division Street  
 Chappel Street  
 E. Lake Shore Rd.  
 Water St.  
 Division Street  
 Division Street  
 Division Street  
 Division Street  
 Monaghan Rd.  
 E. Lake Shore Rd.  
 Woodford Rd.  
 Woodford Rd.  
 E. Lake Shore Rd.  
 Division Street  
 Division St.  
 Titus Rd.  
 Titus Rd.  
 Ward Rd.  
 Division Street  
 E. Lake Shore Rd.  
 Monaghan Rd.  
 Huntington Ln.  
 Chappel Street  
 Woodford Rd.  
 Division Street  
 Airport Rd.  
 Division St.



Stegkemper, Robert  
 Sternberger, Christian  
 Sternberger's Saloon  
 Stevenson,  
 Sticklorath  
 Stokes Winery  
 Stoll, Andy  
 Stoll, Andy  
 Stone Wall, Woodford Rd.  
 Stone Wall, Long Point  
 Stone School  
 Stone Wall, Fire Lanes  
 Stone Wall, Lincoln Rd.  
 Stone Church  
 Strasser/Brennan  
 Stueber, Dr. Paul  
 Svihlik, John  
 Sunrise Point  
 Sweet Valley Wine Co.  
 Taylor's Toe Hold  
 Taylor's Work Shed  
 Thinnies, Peter  
 Timothy House  
 Titus, Justus  
 Titus, William  
 Tommy the Peddler's Store  
 Towle House  
 Town Hall  
 Trieschman, Henry Jr.  
 Trieschman, Henry  
 Trieschman's Meat Mmarket  
 Twidney, William  
 Twine Shanty  
 Union Wine Co.  
 Upp's Cottaage  
 Vest, Alvis & Ada  
 VFW Post 8908  
 Vogt (aka Voight), Elizabeth  
 Vogt (aka Voight), Loui  
 Voltz, Thomas W.  
 Volz, Frank  
 Wall, South Shore Retaining  
 Ward, Burt  
 Ward, Edmond  
 Ward, Uri  
 Ward's Hotel  
 Watkins, Robert & Kim  
 Weintraub, Lenny  
 Wells, Charles  
 West Bay Dock  
 West-Bay Inn  
 West Bay Maintenance Shops  
 "West End Club"  
 West/Martin  
 "Wigwam"  
 Williams, Roger & Madeleine  
 Woodford, Homer  
 Woodford, Jesse E.  
 Worden, Henry  
 Yaniga, Gail  
 Yascovits, George & Molly  
 Zettler, William  
 Zettler, Toby  
 Zettler's Wine Tasting Room  
 Zion United Methodist Church  
 Zitte, Richard & Scotty

ERI-I731  
 ERI-I558  
 ERI-I613  
 ERI-I693  
 ERI-I533  
 ERI-I637  
 ERI-I614  
 ERI-I666  
 ERI-I670  
 ERI-I664  
 ERI-I574  
 ERI-I670  
 ERI-I664  
 ERI-I581  
 ERI-I597  
 ERI-I633  
 ERI-I615  
 ERI-I648  
 ERI-I618  
 ERI-I714  
 ERI-I671  
 ERI-I698  
 ERI-I683  
 ERI-I615  
 ERI-I636  
 ERI-I519  
 ERI-I700  
 ERI-I560  
 ERI-I747  
 ERI-I573  
 ERI-I563  
 ERI-I595  
 ERI-I648  
 ERI-I652  
 ERI-I672  
 ERI-I568  
 ERI-I614  
 ERI-I570  
 ERI-I679  
 ERI-I717  
 ERI-I674  
 ERI-I629  
 ERI-I586  
 ERI-I672  
 ERI-I599  
 ERI-I693  
 ERI-I677  
 ERI-I720  
 ERI-I652  
 ERI-I729  
 ERI-I703  
 ERI-I539  
 ERI-I727  
 ERI-I571  
 ERI-I758  
 ERI-I754  
 ERI-I749  
 ERI-I751  
 ERI-I612  
 ERI-I613  
 ERI-I675  
 ERI-I692  
 ERI-I690  
 ERI-I745  
 ERI-I548  
 ERI-I542

Water St.  
 Chappel Street  
 Chappel Street  
 Water ST.  
 Cameron Road  
 Lincoln Rd.  
 Division St.  
 Titus Rd.  
 Woodford Rd.  
 Monaghan Rd.  
 Division Street  
 Woodford Rd.  
 Monaghan Rd.  
 Division Street  
 Division St.  
 Dwelle Lane  
 Division St.  
 E. Lake Shore Rd.  
 Division Street  
 Water St.  
 Water St.  
 Water St.  
 Water St.  
 Division St.  
 Lincoln Rd.  
 Huntington Ln.  
 Water St.  
 Division Street  
 Woodford Rd.  
 Division Street  
 Division St.  
 Division Street  
 E. Lake Shore Rd.  
 E. Lake Shore Rd.  
 Ward Rd.  
 Division Street  
 Division St.  
 Woodford Rd.  
 Ward Rd.  
 Water St.  
 Ward Rd.  
 Water St.  
 Division Street  
 Ward Rd.  
 Division Street  
 Water St.  
 Ward Rd.  
 Water St.  
 E. Lake Shore Rd.  
 Water St.  
 Water St.  
 Bookerman Road  
 Water St.  
 Woodford Rd.  
 Harbor Ln.  
 McGettigan Ln.  
 Woodford Rd.  
 Woodford Rd.  
 Division Street  
 Chappel Street  
 Ward Rd.  
 Water St.  
 Water St.  
 Woodford Rd.  
 Chappel Street  
 Bookerman Road

ADDENDUM

ADDISON ROAD

ERI-1525	Frank Kelley	#17 - Should read "1884" (Will of Addison Kelley, Hayes Presidential Center)
1527	Frederick Kelley	See Revised Form #43 - Reverse, Para. 2, L5 should read a fireplace & French doors were added in the living room by Fredrena Kelley and her husband, Titus Hamilton."  Reverse, Para. 3, L5: completed date to read "1882".
1528	Hodgson / Elfers	#43 - L5, Charles Earvey to read "Charles (aka Carl, Karl) Earney (aka Erne).



SEE ADDENDUM FOR ADDITIONAL/CORRECTED INFORMATION

Ohio Historic Preservation Office

1985 Velma Avenue  
Columbus, Ohio 43211  
614 466-1500OHIO  
HISTORICAL  
SOCIETY  
SINCE 1885

## OHIO HISTORIC INVENTORY

1. No. ERI-1525		4. Present Name(s) Crotser Residence		1. No. ERI-1525	
2. County Erie		5. Other Name(s) Frank Kelley Residence			2. County ERIE
3. Location of Negatives OHS					
6. Specific Location East side of Addison St., first north of Kelley Mansion		16. Thematic Category Manufactur., commerce		4. Present Name(s) CROTSEY RESIDENCE	
7. City or Town Kelley's Island		17. Date(s) or Period 1881			
8. Site Plan with North Arrow Woodford Rd.		18. Style or Design Vernacular with 2nd Empire elements			
9. U.T.M. Reference 17 35 28 40 46 05 84 0		19. Architect or Engineer		5. Other Name(s) FRANK KELLEY RESIDENCE	
10. Site Building <input checked="" type="checkbox"/> Structure <input type="checkbox"/> Object <input type="checkbox"/>		20. Contractor or Builder			
11. On National Register? Yes <input type="checkbox"/> No <input checked="" type="checkbox"/>		21. Original Use, if apparent Residence			
12. Is It Eligible? Yes <input type="checkbox"/> No <input checked="" type="checkbox"/>		22. Present Use Residence		6. Other Name(s) FRANK KELLEY RESIDENCE	
13. Part of Estab. Hist. Dist.? Yes <input type="checkbox"/> No <input checked="" type="checkbox"/>		23. Ownership Public <input type="checkbox"/> Private <input checked="" type="checkbox"/>			
14. District Potent'l? Yes <input checked="" type="checkbox"/> No <input type="checkbox"/>		24. Owner's Name & Address, if known Wm. Crotser 19 Owassa Dr. Timberlake, Oh 44094			
15. Name of Established District N/A		25. Open to Public? Yes <input type="checkbox"/> No <input checked="" type="checkbox"/>		7. Other Name(s) FRANK KELLEY RESIDENCE	
		26. Local Contact Person or Organization Kevin Pape, K.I. Survey			
		27. Other Surveys in Which Included N/A			
42. Further Description of Important Features (Continue on reverse if necessary) A single brick chimney rises from the center of a pressed metal mansard roof. A front facing end pavilion projects above the roof line and is capped by a hipped gable roof. The hipped gable is pierced by a front facing wall dormer that also has a hipped roof. The dormer has a dentilated cornice and is capped by an ornamental central finial. Its window is a					
43. History and Significance This house was built for Frank Kelley, son of Addison, in 1881. He and his wife lived here until Addison died, they then moved to Addison's mansion and Frank's sister-in-law, Angeline (widow of brother Fredrick), lived here. Frank Kelley was Superintendent of the Kelleys Island Wine Co. in 1887. circa 1926, the house was owned by the family of Frank and Stella Lange. Frank					
44. Description of Environment and Outbuildings This unique building sits in a mowed lot that borders the northern edge of the Addison Kelley Estate. A sidewalk leads from the front porch to the street. A gable roofed, board and batten carriage house (now garage) sits in the northeast corner of the lot. It has a corrugated metal					
45. Sources of Information Observation Frank Hamilton and Jeanette Cleary, Kelley descendants		46. Prepared by B. Pape & J. Campbell		8/85	
		47. Organization K.I. Plann. Comm.			
		48. Date 8/85			
		49. Revision Date(s)			



## 50. House Type No.

Code No. Name

## 51. Historic Outbuildings and Dependencies

Barn Type(s)

Code No. Type

Corn Crib or Shed ☐  
Silo ☐  
Summer Kitchen ☐

Smoke House, ☐  
Spring House  
or Ice House

Privy ☐  
Carriage House ☒

Other \_\_\_\_\_

## 52. Archaeological Site on Property?

Yes ☐  
No ☒

Basis for Information

Owner Collection ☐  
Above Ground Earthworks or Mound ☐  
Cultural Materials Noted ☐

OAI No. \_\_\_\_\_

## 53. Farmstead Plan

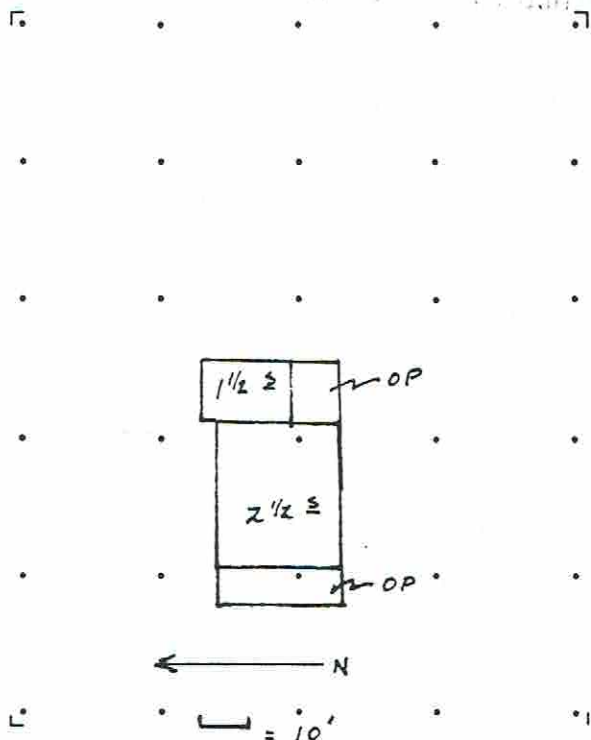

## 54. Photo

Roll No.

21

Picture No(s).

9&amp;10

double hung, 1/1 light with a stone lug sill. Wall dormers also pierce the mansard on the north and south sides of the house. The dormers are finished with ship-lap siding and have plain cornices. Their windows are double hung 1/1 and 2/1 light on the south and north sides respectively, sills are stone lug. Windows in the rest of the house are double hung 1/1 light and are positioned symmetrically across the first and second floors. In the front of the house, the end pavillion is pierced by two windows each on the first and second floors while the opposite end of the wall contains a doorway with transoms on the first floor and two 3/4 size windows to balance the second floor. An open porch projects out from the front of the house. Its hipped roof is supported by round columns placed atop coursed limestone block pillars. In the rear of the house is a 1 1/2 story wing. A brick chimney rises from the east end of a tarpapered gable roof. The frame structure is finished with clapboard siding and end boards. A small porch juts off the rear of the wing. A mansard roofed porch extends out from the east wall of the main block and protects the rear entrance. Additions and alterations include some replacement windows, the front porch, and the frame wing in the rear.

#43 (cont'd) worked as a clerk in the office of the Kelleys Island Lime and Transport Co. After the quarry closed he went into partnership with Walter Brown to operate Lange and Brown General Store which they bought from John Reinheimer. Walter's sons, Howard and Clifford, succeeded their father at the store.

#44 (cont'd) roof and a barn style double sliding door. Windows include a double hung 6/6 light, a single hung 6 light, and a single hung 3 light.



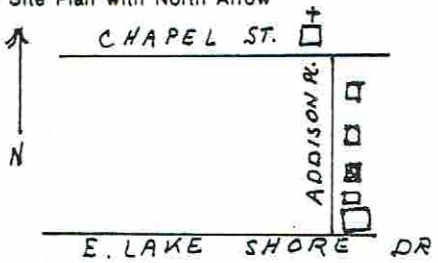
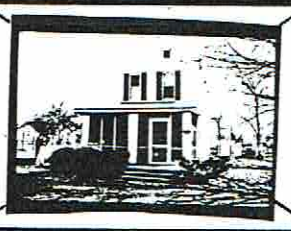

## OHIO HISTORIC INVENTORY

1. No. ERI-1526		4. Present Name(s) Adelbert L. and Laverne Ehrbar Residence		1. No. ERI-1526 2. County Erie 4. Present Name(s) Adelbert L. & Laverne Ehrbar 5. Other Name(s)
2. County ERIE		5. Other Name(s) N/A		
3. Location of Negatives O.H.S.				
6. Specific Location East side of Addison Pl., 2nd house north of the Kelley Mansion.		16. Thematic Category Manufact., Commerce		28. No. of Stories 2 29. Basement? crawl Space Yes <input type="checkbox"/> No <input checked="" type="checkbox"/> 30. Foundation Material Lime stn rubble 31. Wall Construction Wood frame balloon 32. Roof Type & Material metal Channeled, pyramidal 33. No. of Bays Front 2 Side 2 34. Wall Treatment Ship-lap over stucco 35. Plan Shape Square 36. Changes (Explain in #42) Addition <input checked="" type="checkbox"/> Altered <input checked="" type="checkbox"/> Moved <input type="checkbox"/> 37. Condition Interior Good Exterior Good 38. Preservation Underway? Yes <input checked="" type="checkbox"/> No <input type="checkbox"/> 39. Endangered? By What? Yes <input type="checkbox"/> No <input checked="" type="checkbox"/> 40. Visible from Public Road? Yes <input checked="" type="checkbox"/> No <input type="checkbox"/> 41. Distance from and Frontage on Road 50' / 115'
7. City or Town If Rural, Township & Vicinity Kelleys Island, Ohio		17. Date(s) or Period c. 1880		
8. Site Plan with North Arrow 		18. Style or Design Vernacular		
		19. Architect or Engineer		
		20. Contractor or Builder		
		21. Original Use, if apparent Residence		
		22. Present Use Residence		
		23. Ownership Public <input type="checkbox"/> Private <input checked="" type="checkbox"/>		
		24. Owner's Name & Address, if known Adelbert & Laverne Ehrbar, Kelleys Island Ohio		
		25. Open to Public? Yes <input type="checkbox"/> No <input checked="" type="checkbox"/>		
9. U.T.M. Reference 17 357860 4605900 Zone Easting Northing		26. Local Contact Person or Organization Kevin Pape: K.I. Hist. Survey		
10. Site Building <input checked="" type="checkbox"/> Structure Object <input type="checkbox"/>		27. Other Surveys in Which Included N/A		
11. On National Register? Yes <input type="checkbox"/> No <input checked="" type="checkbox"/>				
12. Is It Eligible? Yes <input type="checkbox"/> No <input checked="" type="checkbox"/>				
13. Part of Estab. Hist. Dist.? Yes <input type="checkbox"/> No <input checked="" type="checkbox"/>				
14. District Potent'l? Yes <input checked="" type="checkbox"/> No <input type="checkbox"/>				
15. Name of Established District N/A				
42. Further Description of Important Features (Continue on reverse if necessary) Like other homes associated with the Kelley family (eg ERI-1525, ERI-1645, and ERI-1685) the design configuration of this house is unique on the island. Its 2 by 2 bay plan is capped by a channeled metal, pyramidal roof with central brick chimney and ventilation shuttle. The front facade is dominated by a hip-roofed, screened porch. Windows are double-hung, 2/2 light except for a "picture"				
43. History and Significance Oral tradition indicates that this house was built by Addison Kelley as a home for the house maid or hired hand at his mansion (ERI-1645), some time after 1874. Between c 1890 and 1927 it was probably rented to various families but remained in the hands of the Kelley family. In 1927 it was purchased by Lawrence C. and Marie Barth Ehrbar, parents of the pre-				
44. Description of Environment and Outbuildings House stands on a quiet, tree shaded street, and surrounded by mature trees. Vestiges of an old orchard and overgrown farm land lies to the east. A three-car garage or barn has been converted to a guest cottage. A small, vinyl sided storage shed is at the rear of the lot, and, in the southeast.				
45. Sources of Information N. Hill, History of Kelleys Island, Ohio Hamilton Collection, Hayes Presidential Center 1874 Atlas Erie County - 1896 Map of Kelleys Island Oral History: A.L. Ehrbar J. Cleary				46. Prepared by Betty Pape 47. Organization K.I. Planning Comm. 48. Date 9/85 49. Revision Date(s)

## 50. House Type No.

Code No. Name

\_\_\_\_\_

## 51. Historic Outbuildings and Dependencies

Barn Type(s)

Code No. Type

\_\_\_\_\_

\_\_\_\_\_

\_\_\_\_\_

Corn Crib or Shed ☐ Smoke House, ☐ Privy ☐  
Silo ☐ Spring House ☐ Carriage House ☐  
Summer Kitchen ☐ or Ice House

Other \_\_\_\_\_

## 52. Archaeological Site on Property?

Yes ☐No ☐

Basis for Information

Owner Collection ☐Above Ground Earthworks or Mound ☐Cultural Materials Noted ☐

OAI No. \_\_\_\_\_

## 53. Farmstead Plan



## 54. Photo

Roll No. 25-B Picture No(s). 4

42. (Cont'd) window in the south wall and set in plain frames. Except for end boards, there are no trim elements or details on the flush, ship-lap walls. Other than the replaced window, the only exterior alteration is an enclosed, hip-roofed vestibule covering the rear door.

## 43. (Cont'd.)

sent owner, from Frederina Kelley Hamilton. (ERI-1527) From that date to the present it has been used as a summer home for members of the Ehrbar family.



## 44. (Cont'd.)

corner of the lot, a unique, double, three-hole privy.



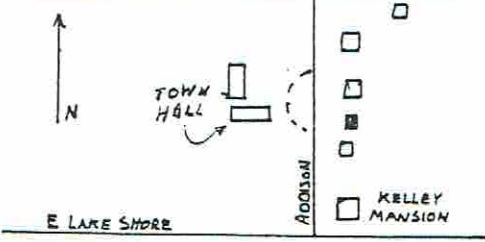

## OHIO HISTORIC INVENTORY

1. ERI-1527		4. Present Name(s) Jeannette and George Cleary Residence		1. No. ERI-1527 2. County Erie 4. Present Name(s) Jeannette and George Cleary Res. 5. Other Name(s) Frederick Kelley / Titus Hamilton Hse.
2. County ERIE		5. Other Name(s)		
3. Location of Negatives O.H.S.		Frederick Kelley / Titus Hamilton House		
6. Specific Location East side of Addison Pl., 600 ft. south of its inter- section with Woodford Rd.		16. Thematic Category Commerce, Industry		28. No. of Stories 1½
7. City or Town If Rural, Township & Vicinity Kelleys Island		17. Date(s) or Period c.1862		29. Basement? Yes <input checked="" type="checkbox"/> No <input type="checkbox"/>
8. Site Plan with North Arrow 		18. Style or Design Gothic Revival		30. Foundation Material Coursed Limestone
		19. Architect or Engineer -		31. Wall Construction Stone bearing wall
		20. Contractor or Builder -		32. Roof Type & Material Gable/asph shingle
		21. Original Use, if apparent Residence		33. No. of Bays Front 3 Side 2
		22. Present Use Residence		34. Wall Treatment Stucco over limestn
		23. Ownership Public <input type="checkbox"/> Private <input checked="" type="checkbox"/>		35. Plan Shape Rectangle
		24. Owner's Name & Address, if known Jeannette Cleary 129 Farland Ave. Highland Park, Mich. 48203		36. Changes (Explain in #42) Addition <input checked="" type="checkbox"/> Altered <input type="checkbox"/> Moved <input type="checkbox"/>
9. U.T.M. Reference 17 35 7 8 6 0 4 6 0 5 9 0 0		25. Open to Public? Yes <input type="checkbox"/> No <input checked="" type="checkbox"/>		37. Condition Interior Excel Exterior good
Zone Easting Northing		26. Local Contact Person or Organization Kevin Pape: K.I.Hist Survey		38. Preservation Underway? Yes <input checked="" type="checkbox"/> No <input type="checkbox"/>
10. Site <input type="checkbox"/> Building <input checked="" type="checkbox"/> Structure <input type="checkbox"/> Object <input type="checkbox"/>		27. Other Surveys in Which Included N/A		39. Endangered? By What? Yes <input type="checkbox"/> No <input checked="" type="checkbox"/>
11. On National Register? Yes <input type="checkbox"/> No <input checked="" type="checkbox"/>				40. Visible from Public Road? Yes <input checked="" type="checkbox"/> No <input type="checkbox"/>
12. Is It Eligible? Yes <input checked="" type="checkbox"/> No <input type="checkbox"/>				41. Distance from and Frontage on Road 70'x 60'
13. Part of Estab. Hist. Dist.? Yes <input type="checkbox"/> No <input checked="" type="checkbox"/>				
14. District Potent'l? Yes <input checked="" type="checkbox"/> No <input type="checkbox"/>				
15. Name of Established District N/A				
42. Further Description of Important Features (Continue on reverse if necessary) A central brick chimney tops the steeply pitched, gable roof. Windows are predominantly double-hung 6/6 or 2/2 lights with plain lug sills. A Gothic arched window is found under the front gable. The front door features a plain sill and hood. A stone water table runs above the foundation. A gable-roofed, one-story frame addition, comprising a kitchen, bath and screened porch was ex-				5. Other Name(s) Frederick Kelley/Titus Hamilton Hse.
43. History and Significance Four of the most distinctive Gothic Revival houses on the island were built by members of the Kelley family. This house is identical in plan, roof form, construction material, and fenestration to the Charles and Edwin Kelley House, ERI-1604. It was built for Frederick Kelley by his father, Addison Kelley c.1862. Born on the island in 1839, Frederick began his				
44. Description of Environment and Outbuildings The house is located on a tree-lined street in a quiet residential area. An original barn burned in 1903, but present outbuildings include a 21'x 27' gable-roofed, frame barn/garage, and a frame privy. Remains of a large				
45. Sources of Information Census Records, Erie Co. Erie Co. Gen'l Index to Deeds; Grand List Tx. Rec., 1859 1874 Atlas, Erie Co. Oral Hist: Frank Hamilton, Jeannette Hamilton Cleary		46. Prepared by Kevin Pape Betty Pape 47. Organization K.I. Planning Commis 48. Date 8/85 49. Revision Date(s)		



## 50. House Type No.

Code No. Name

## 51. Historic Outbuildings and Dependencies

## Barn Type(s)

Code No. Type

\_\_\_\_\_

\_\_\_\_\_

\_\_\_\_\_

Corn Crib or Shed ☐ Smoke House, ☐ Privy ☒  
 Silo ☐ Spring House Carriage House ☒  
 Summer Kitchen ☐ or Ice House

Other \_\_\_\_\_

## 52. Archaeological Site on Property?

Yes ☐  
 No ☐

## Basis for Information

Owner Collection ☐  
 Above Ground Earthworks or Mound ☐  
 Cultural Materials Noted ☐ OAI No. \_\_\_\_\_

## 53. Farmstead Plan

☐ PRIVY

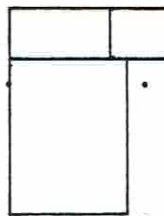

0 10 20 FT

N

## 54. Photo

Roll No. 21 Picture No(s). 12

## 42. (Cont'd)

tended from the rear (east) wall, with the porch appearing as a wing beyond the southeast corner.

## 43.. (Cont'd.)

working career as a fisherman while still living with his father (1860 Census). He also helped in the management of his father's estate as well as his own lands to the northeast. In January of 1863 he married Angeline Woodford, daughter of Jesse E. and Harriet Woodford (ERI-1751). The following year, Frederick died just before the birth of his daughter, Fredrena. Mrs. Kelley and her baby daughter then moved into the home of her father-in-law (ERI-1645) where Fredrena grew up.

The house was then rented to various island families including that of couzin, Charles Kelley and his wife Ada Prommer. This probably would have been after the date of their marriage in 1866. Later, brother-in-law, George Bristol and his wife, Electa Woodford, lived here as well as the William Burgers. It was the Bristols who changed the existing French doors in the west wall to permanent windows, and installed a fireplace in this room.

When Fredrena married Titus Hamilton in 1888, they took up residency here after a brief stay in the Farciot House (1688). Titus, born on Kelleys Island in 1845, was the son of James and Sabra Titus Hamilton of Ward Rd. (house recently razed). He built and operated a winery on his father's \*land which he sold in 18 to Willaim Becker (see ERI-1678). The year of his marriage he took over the management of his brother-in-law, Erastus Huntington's store (ERI-1562), which he operated until 1904. During his proprietorship, the "Lodge" continued as an informal social club and Titus was considered to be one of its champion checker players. After selling the store to John Reinheimer, Mr. Hamilton managed his mother's estate on the north shore and entered the squab business, maintaining a flock of



OHIO HISTORIC INVENTROY

ERI-1527

ERIE

O.H.S.

Jeannette and George Cleary Residence  
Frederick Kelley / Titus Hamilton House

43. (Cont'd.)

2000 birds. It was probably at this time that a large chicken house and smithy shed were built at the eastern edge of the house lot. During his life on the island, Titus was nine times the editor of its weekly newspaper, "The Islander". Mr. Hamilton died in 1913, his wife in 1946.

Their son, Frank, became a noted lake captain and historian of island and lake lore. His material, now housed at the Hayes Presidential Center, Fremont, Ohio, includes extensive files on island history which has served as an invaluable reference for this inventory. Until his death, Frank, and his wife, Katherine, lived in the former Erastus Huntington home known as "The Inn" (ERI-1707). His sister, Jeannette Hamilton Cleary, active in Detroit community affairs, is the present owner of the family home and summers here with her husband.

44. (Cont'd.)

chicken house and smithy shed, almost hidden by scrub, lie east of a wire fence that encloses the rear yard.

45. (Cont'd.)

Erie Co. Deeds, Vol 23, p.167

Erie Co. Grand List, 1890

ERI-1527  
Erie

Jeannette & George Cleary Res.

Frederick Kelley/Titus Hamilton Hse.



## OHIO HISTORIC INVENTORY

1. No. ERI-1528	4. Present Name(s) Hodgson/Bockerman House		1. No. ERI-1528 2. County Erie 4. Present Name(s) Hodgson / Bockerman 5. Other Name(s) Elfers / Bockerman House
2. County ERIE	5. Other Name(s) Elfers/Bockerman House		
3. Location of Negatives O.H.S.			
6. Specific Location East side of Addison Pl., 4th house from its inter. with E. Lake Shore Dr.		16. Thematic Category Ethnic, Commercial, Agric.	28. No. of Stories 2
7. City or Town If Rural, Township & Vicinity Kelleys Island, Ohio		17. Date(s) or Period c. 1880	29. Basement? Yes <input checked="" type="checkbox"/> No <input type="checkbox"/>
8. Site Plan with North Arrow CHAPEL <input type="checkbox"/> ADDISON RD. <input type="checkbox"/> KELLEY MANSION <input type="checkbox"/> E. LAKE SHORE DR. <input type="checkbox"/>		18. Style or Design Italianate, vernacular	30. Foundation Material Limestone ashlar
		19. Architect or Engineer	31. Wall Construction Wood frame
		20. Contractor or Builder	32. Roof Type & Material Gable/asph shingle
		21. Original Use, if apparent Residence	33. No. of Bays Front 5 Side
		22. Present Use Residence	34. Wall Treatment Weather/Revel Bd.
		23. Ownership Public <input type="checkbox"/> Private <input checked="" type="checkbox"/>	35. Plan Shape irreg.
		24. Owner's Name & Address, if known James Hodgson 1438 Northland Ave., Lakewood, Ohio, 44107	36. Changes (Explain in #42) Addition <input checked="" type="checkbox"/> Altered <input checked="" type="checkbox"/> Moved <input type="checkbox"/>
9. U.T.M. Reference 17 357910 4605980		25. Open to Public? Yes <input type="checkbox"/> No <input checked="" type="checkbox"/>	37. Condition Interior Excellent Exterior Excellent
10. Zone Easting Northing Site <input type="checkbox"/> Building <input checked="" type="checkbox"/> Structure <input type="checkbox"/> Object <input type="checkbox"/>		26. Local Contact Person or Organization Kevin Pape: K.I. Hist. Survey	38. Preservation Underway? Yes <input checked="" type="checkbox"/> No <input type="checkbox"/>
11. On National Register? Yes <input type="checkbox"/> No <input checked="" type="checkbox"/>		27. Other Surveys in Which Included N/A	39. Endangered? By What? Yes <input type="checkbox"/> No <input checked="" type="checkbox"/>
12. Is It Eligible? Yes <input checked="" type="checkbox"/> No <input type="checkbox"/>			40. Visible from Public Road? Yes <input checked="" type="checkbox"/> No <input type="checkbox"/>
13. Part of Estab. Hist. Dist.? Yes <input type="checkbox"/> No <input checked="" type="checkbox"/>			41. Distance from and Frontage on Road 50'
14. District Potent'l? Yes <input checked="" type="checkbox"/> No <input type="checkbox"/>			
15. Name of Established District N/A			
42. Further Description of Important Features (Continue on reverse if necessary) This gable-front-and-wing building features a five bay, front facade with doorways in both the gable and eave walls. The moderately sloping gable roof has overhanging eaves which project over a wide frieze board set on end boards. Trim elements are focused on doors and windows which feature framed surrounds and pedimented lintels with pendant drips and a central milled design. Both front doors are access			
43. History and Significance This house was built in the early 1880's by Frederick Elfers, merchant and grape grower, who came to Kelleys Island in 1861 as a boy of 15, from his home in Hanover, Germany. It was probably at the suggestion of his brother, Henry, who had arrived on the island 2 years earlier. By 1865 Frederick was living with a Swiss farmer, Charles Earvey, and working in			
44. Description of Environment and Outbuildings The house sits on a well kept lawn, shaded by mature trees. A huge block of limestone, placed there by the previous owner, makes a dramatic statement. Henry Elfers had built a house, similar in plan and exterior,			
45. Sources of Information Census Records; Schedule 2, Prod. of Agriculture Aldrich, History of Erie County, Ohio Hill, History of Kelleys Island, Ohio M. Bockerman Hamilton Collection, Hayes Presidential Center			46. Prepared by Kevin & B. Pape
			47. Organization K.I. Planning Comm.
			48. Date 10/85
			49. Revision Date(s)



## 50. House Type No.

Code No. Name

## 51. Historic Outbuildings and Dependencies

Barn Type(s)

Code No. Type

Corn Crib or Shed ☐ Smoke House ☐ Privy ☐  
 Silo ☐ Spring House ☐ Carriage House ☐  
 Summer Kitchen ☐ or Ice House

Other \_\_\_\_\_

## 52. Archaeological Site on Property?

Yes ☐  
 No ☐

Basis for Information

Owner Collection ☐  
 Above Ground Earthworks or Mound ☐  
 Cultural Materials Noted ☐ OAI No. \_\_\_\_\_

## 53. Farmstead Plan

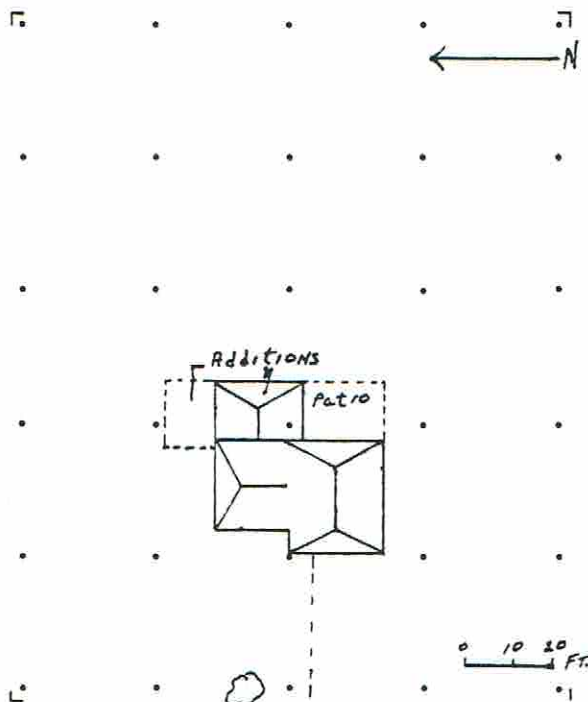

## 54. Photo

Roll No. 6 Picture No(s). 5

the vineyards. When only 19 he started business for himself by leasing 5½ acres of vineyards on an indenture basis from Addison Kelley, a lease which he continued even after 1888. In 1876, 5 years after his marriage to Sophia Koster, sister of Herman Koster, and with no previous experience, he entered the mercantile business. With A. Heckerman, a carpenter, also from Hanover, they built and stocked the second general store on the island. This building probably preceded the present Gerlach/McKillips workshop (ERI-1626) 2 blocks north on Division St. In 1883, when John Reinheimer left his general store (ERI-1559) to operate the Boat Dock (ERI-1628), Fred took over this store, and in 1884 when appointed Post Master, built a small addition to the south wall of his store to house the Post Office. A year later he contracted with August Schaedler to build a "fine new store" across Division St. that was to incorporate the newest in technical and decorative innovations (ERI-1564) including the first electric lighting system in Erie County. A mechanical and inventive genius, Mr. Elfers devised many labor saving devices which he incorporated in to both his home and his store. He was the first photographer on the island and built a darkroom in his home. He was also the first to have a speed boat.

44. (Cont'd.)



and at approximately the same time. This house was later used as the rectory for St. Michael's Church, but burned in 1935. The house to the north of this now vacant lot (ERI-1528) was also in the Elfers family.

42. (Cont'd.) ed by dressed limestone steps. Windows are predominantly 2/2, double-hung. Additions and alterations include an exterior, eave-wall, rubble limestone chimney that is pierced by "French" doors in the second story on the south wall. A single-story wing is attached to the eastern eave wall and a shed-roofed utility addition has been built onto its northern wall. Other alterations include a twelve, a fifteen, and an eighteen light, single sash window in the rear of the house.



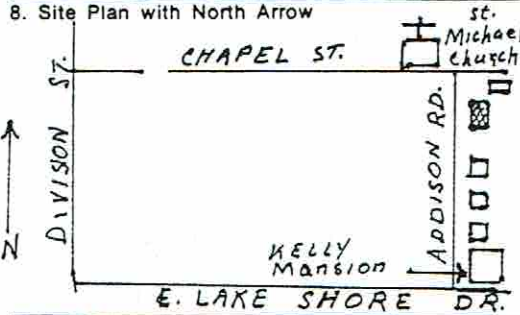

## OHIO HISTORIC INVENTORY

1. No. ERI-1529		4. Present Name(s) Lucille Matthews House		1. No. ERI-1529 2. County Erie 4. Present Name(s) Lucille Matthews Residence 5. Other Name(s) Walter Elfers House
2. County ERIE		5. Other Name(s) Walter Elfers House		
3. Location of Negatives O.H.S.				
6. Specific Location The last house on east side of Addison Pl. before its intersect. with Chapel		16. Thematic Category Manufacturing		28. No. of Stories 2
7. City or Town If Rural, Township & Vicinity Kelley's Island, Ohio		17. Date(s) or Period 1885 / 1909		29. Basement? Yes <input checked="" type="checkbox"/> No <input type="checkbox"/>
8. Site Plan with North Arrow 		18. Style or Design Vernacular		30. Foundation Material Regular l.s. ashlar
		19. Architect or Engineer		31. Wall Construction Wood frame
		20. Contractor or Builder		32. Roof Type & Material Gable/asph shingle
		21. Original Use, if apparent Residence		33. No. of Bays Front Side
		22. Present Use Residence		34. Wall Treatment Clapboard
		23. Ownership Public <input type="checkbox"/> Private <input checked="" type="checkbox"/>		35. Plan Shape "L"
		24. Owner's Name & Address If known Lucille Matthews Kelley's Island, Ohio		36. Changes (Explain in #42) Addition <input checked="" type="checkbox"/> Altered <input type="checkbox"/> Moved <input checked="" type="checkbox"/>
9. U.T.M. Reference 17 357930 4606050 Eastings Northings Site <input type="checkbox"/> Building <input checked="" type="checkbox"/> Structure <input type="checkbox"/> Object <input type="checkbox"/>		25. Open to Public? Yes <input type="checkbox"/> No <input checked="" type="checkbox"/>		37. Condition Interior Good Exterior Good
11. On National Register? Yes <input type="checkbox"/> No <input checked="" type="checkbox"/>		26. Local Contact Person or Organization Kevin Pape: K.I. Hist. Survey		38. Preservation Underway? Yes <input checked="" type="checkbox"/> No <input type="checkbox"/>
12. Is It Eligible? Yes <input type="checkbox"/> No <input checked="" type="checkbox"/>		27. Other Surveys in Which Included N/A		39. Endangered? By What? Yes <input type="checkbox"/> No <input checked="" type="checkbox"/>
13. Part of Estab. Hist. Dist.? Yes <input type="checkbox"/> No <input checked="" type="checkbox"/>				40. Visible from Public Road? Yes <input checked="" type="checkbox"/> No <input type="checkbox"/>
14. District Potent'l? Yes <input checked="" type="checkbox"/> No <input type="checkbox"/>				41. Distance from and Frontage on Road 65
15. Name of Established District N/A				
42. Further Description of Important Features (Continue on reverse if necessary) The facade of this gable-front-and-wing house is dominated by a screened porch that curves around to enclose the front gable as well as the "L". A one-story, gabled wing is attached to the east gable wall. This section has been expanded by the addition of a shed-roofed addition to the south. Windows are a mixture of 2/2 and 1/1, double-hung types and trim elements are restricted to frieze-				
43. History and Significance In 1909 this house was moved from the rear of the former home of Henry Elfers just to the south (burned in 1936). C 1885 Henry Elfers, a farmer and grape grower, ran his home as a small private hotel with "a barn and neat cottage to the rear". It was probably this cottage that was the building moved for the use of Henry's son, Walter. Walter, born on Kelley				
44. Description of Environment and Outbuildings House sits on a mowed flat lawn shaded by mature trees. A small, gable-roofed board & batten cottage is located to the north and rear of the main house. Of more recent construction, it incorporates a cannibalised				
Sources of Information Census Records Aldrich, History of Erie County, Ohio Hill, History of Kelley's Island, Ohio Hamilton Collection, Hayes Presidential Center Marshall Rockerman, History of Kelley's Island, Ohio (Cont'd on reverse)				46. Prepared by Kate Boker Kevin & B. Pape
				47. Organization K.I. Planning Comm
				48. Date 10/85
				49. Revision Date(s)



## 50. House Type No.

Code No. Name

## 51. Historic Outbuildings and Dependencies

Barn Type(s)

Code No. Type

Corn Crib or Shed ☐ Smoke House, ☐ Privy ☐  
 Silo ☐ Spring House Carriage House ☐  
 Summer Kitchen ☐ or Ice House

Other \_\_\_\_\_

## 52. Archaeological Site on Property?

Yes ☐  
 No ☐

Basis for Information

Owner Collection ☐  
 Above Ground Earthworks or Mound ☐  
 Cultural Materials Noted ☐ OAI No. \_\_\_\_\_

## 53. Farmstead Plan



← N

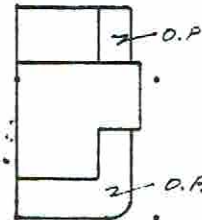

0 10 10 FT.

## 54. Photo

Roll No. 6 Picture No(s) 8-9

## 42. (Cont'd) boards, end boards, and watertable boards.

## #43. (Cont'd.)

Island in 1880, worked for the quarry. He had married Rose Bookerman (aka Bockerman) in 1902 and had a small family when he was blinded in a quarry accident. It is reported that it was the KIL&T Co. that assisted in the moving and conversion of the cottage to a residence for the family as partial compensation. A stone foundation was prepared and the house enlarged when it was moved. Walter added the handsome wrap-around porch, and some time later, a rear stoop. The house remained in the Elfers family until late in 1950 when it was sold to the present owner.

## 44. (Cont'd.)

large, 2/2 lights window from a house of an earlier period, featuring a pedimented frame. The cottage is used as a guest house.

## #45. (Cont'd.)

Sand.Wk.Reg. 8/19/1885: Hist Sketches of K.I.  
 Lucille Matthews  
 1903 Erie Co. Tax Book

Ohio Historic Preservation Office

1985 Veima Avenue  
Columbus, Ohio 43211  
614/466-1500OHIO  
HISTORICAL  
SOCIETY  
SINCE 1885

## OHIO HISTORIC INVENTORY

1. No. ERI-1530		4. Present Name(s) Pohorence House		1. No. ERI-1530 2. County Erie 4. Present Name(s) Pohorence House
2. County ERIE		5. Other Name(s) Herman Koster House		
3. Location of Negatives O.H.S.				
6. Specific Location West side of Addison Rd., first house north of E. Lake Shore Drive.		16. Thematic Category Ethnic Manufact., Agriculture, transp.		28. No. of Stories 2 29. Basement? Yes <input checked="" type="checkbox"/> No <input type="checkbox"/> 30. Foundation Material Limestone rubble 31. Wall Construction Wood frame 32. Roof Type & Material Gable/asph.shingle 33. No. of Bays N-7 Front 5 Side S-4 34. Wall Treatment Asbestos shingle 35. Plan Shape 36. Changes (Explain in #42) Addition <input checked="" type="checkbox"/> Altered <input checked="" type="checkbox"/> Moved <input type="checkbox"/> 37. Condition Interior V.good Exterior V. good 38. Preservation Underway? Yes <input checked="" type="checkbox"/> No <input type="checkbox"/> 39. Endangered? By What? Yes <input type="checkbox"/> No <input checked="" type="checkbox"/> 40. Visible from Public Road? Yes <input checked="" type="checkbox"/> No <input type="checkbox"/> 41. Distance from and Frontage on Road 20' / 61' - 106 A
7. City or Town If Rural, Township & Vicinity Kelleys Island, Ohio		17. Date(s) or Period c. 1870		
8. Site Plan with North Arrow		18. Style or Design Folk Victorian		
		19. Architect or Engineer -		
		20. Contractor or Builder -		
		21. Original Use, if apparent Residence		
		22. Present Use Residence		
9. U.T.M. Reference Zone 17 Easting 357800 Northing 4605890		23. Ownership Public <input type="checkbox"/> Private <input checked="" type="checkbox"/>		
10. Site <input type="checkbox"/> Building <input checked="" type="checkbox"/> Structure <input type="checkbox"/> Object <input type="checkbox"/>		24. Owner's Name & Address, if known Franklin J. Pohorence Box 389, Kelleys Isl.		
11. On National Register? Yes <input type="checkbox"/> No <input checked="" type="checkbox"/>		25. Open to Public? Yes <input type="checkbox"/> No <input checked="" type="checkbox"/>		
12. Is It Eligible? Yes <input checked="" type="checkbox"/> No <input type="checkbox"/>		26. Local Contact Person or Organization Kevin Pape: KI.Historic.Survey		
13. Part of Estab. Hist. Dist.? Yes <input type="checkbox"/> No <input checked="" type="checkbox"/>		27. Other Surveys in Which Included N/A		
14. District Potent'l? Yes <input checked="" type="checkbox"/> No <input type="checkbox"/>				
15. Name of Established District N/A				
42. Further Description of Important Features (Continue on reverse if necessary) This Folk Victorian house is massed in a cross-gable pattern with the main entrance in the front gable end. Two brick chimneys are centrally located on the gable ridge. Three entrances face Addison Pl.; one in the gable end, flanked by doors on either side placed in the eave wall of the cross-gable. Each entrance is protected by a shed-roofed porch. The southern porch is supported by chamfered columns and trimmed with a jig-saw cut frieze board; the door lintel				
43. History and Significance The house was built in 1870 by Herman Koster (aka Kester, Coster) on land he had purchased from Jake Hays in 1859. Court records show there was a house on this property at that time. Koster may have built/used this as his first dwelling until the present house was built. The same records indicate that a house was demolished the same year one was built. Born in Hanover, Germany, 1830, Herman Koster emigrated to the United States in 1854.				
44. Description of Environment and Outbuildings There is a large area of lawn to the south and north. Berry bushes and fruit trees line a south side drive that leads to a shed-roofed, wood frame garage of asphalt brick siding. A fine smokehouse of limestone				5. Other Name(s) Herman Koster House
45. Sources of Information Census Records; 1870 Prod. of Ind., 1880 Prod of Agric. Court Records, Erie Co. Aldrich, History of Erie Co., Ohio, 1889 F.Hamilton Collection, Hayes Presidential Center Frank Pohorence, O.H. Lange; Annie Chevany Pohorence				
46. Prepared by Betty Pape Kevin Pape 47. Organization KI.Planning Commission 48. Date 10/85 49. Revision Date(s)				



## 50. House Type No.

Code No. Name

## 51. Historic Outbuildings and Dependencies

## Barn Type(s)

Code No. Type

Corn Crib or Shed ☐ Smoke House, ☒ Privy ☐  
 Silo ☐ Spring House Carriage House ☐  
 Summer Kitchen ☐ or Ice House

Other \_\_\_\_\_

## 52. Archaeological Site on Property?

Yes ☒  
 No ☐

Basis for Information (ER-355)

Owner Collection ☐  
 Above Ground Earthworks or Mound ☐  
 Cultural Materials Noted ☐ OAI No. \_\_\_\_\_

## 53. Farmstead Plan



## 54. Photo

Roll No. 5 Picture No(s). 34

## 43. (Cont'd.)

coming to Kelleys Island where he found employment in the vineyards. Returning to Hanover c. 1857, he married Katie Brinkman, daughter of Henry and Sophia Rohrs Brinkman, who also was born in Hanover, 1835. They then returned to the island with Herman's brother, Christian, and Katie's widowed mother, who returned to the use of her maiden name after coming to the island. Herman's three sisters, Mary, Sophia, and Kate also emigrated to Kelleys Island about this same time, and may have come over with him on this second trip. He then purchased the 20 acres on which this house was built. They extended from the south shore, north beyond Chapel Street. 4 acres was set out in grapes, and with the later addition of lands in the center of the island, his vineyards numbered 20 acres. Koster first built a small wine cellar and press house to the rear of his house, and in 1870 was producing 800 gallons of wine. He also set out an apple orchard to the north of the house where the Village pavilion now stands. By 1883, his business prospering, he was able to have Irving Kelley design and build a three story, stone cellar and press house on the lake shore at the foot of Addison, with a capacity of 50,000 gallons (ER-355). After his death in 1887, his widow continued to operate the cellar for three years, when its facilities were leased by the Sweet Valley Wine Co. (ERI-1618). A year before his death, he built the dock for his winery now known as "Koster's Dock" (ERI-1650). Earlier, anticipating the marriage of his sons, and aware of a housing shortage on the island, Herman purchased a small two room house on Division Street. This house was occupied by his son, John, and later owned and enlarged by Frederick Lange and Frederick's daughter, Ruth Lange Schnittker (ERI-1600). In the early 1900's, the KIL&T Co. purchased the house and for a while used it as an office that housed their telephone system they had bought from the K.I. Cable Co. in 1899 so as to be able to keep track of their boats and other business. The new cable came aground at the bay just south of the house and east of the Inscription Rock. Later, the house was rented to quarry worker, Joseph Chevneynock and his wife Annie, both Austro-Slovakians who had emigrated to the island in 1893. They first lived at the North Quarry complex (ER-336) where Joseph was working.

## OHIO HISTORIC INVENTORY

Supplementary Sheet

ERI-1530

Pohorence House

## 43. (Cont'd.)

Between 1920 and 1939 they rented the present house from the KIL&T. Co. C. 1930 they acted as caretakers for the Kelley Mansion (ERI-1645), and their daughter, Annie Chevneynock (aka Chevany) Pohorence, remembered cleaning for Mrs. Frank Kelley and her sister. Annie, born on Kelleys Island in 1897, married Joseph Pohorence, an island fisherman. They lived in several different houses, all in this area, before purchasing this house from the KIL&T Co. in 1942. Mr. Pohorence worked from Koster's Dock (ERI-1650) for the Lay Brothers Fish Co. Their son, Franklin, was the operator/owner of The Island Market, formerly Trieschman's (ERI-1563), from 194 to 1984.

ERI-1530

Erie

Pohorence House

Herman Koster House



ADDENDUM

CAMERON / BOOKERMAN ROADS

ERI-1533 KILT Worker's Hse. #43 - L3: Feyelelem to read "Feyedelem"  
1539 West Bay Shops #53 - Should bear the title heading  
"Maintenance Shops as shown on  
the Sanborn Insurance Map of  
1905".  
1543 Palazza/D. Huntington #43 - Reverse, L16+17: Both brothers...  
to read " The brothers married  
couzins; Elmer marrying Matilda  
Meier Dickman, and William marry-  
ing Minnie Schnittker, daughter  
of August Schnittker of Pitts-  
burgh. See ERI-1568.